



**HEIDENHAIN**



**Montageanleitung**  
***Mounting Instructions***  
**Instructions de montage**  
***Istruzioni di montaggio***  
**Instrucciones de montaje**

**RON 285**  
**RON 285 C**

11/2003





Maße in mm  
Dimensions in mm  
Cotes en mm  
Dimensioni in mm  
Dimensiones en mm

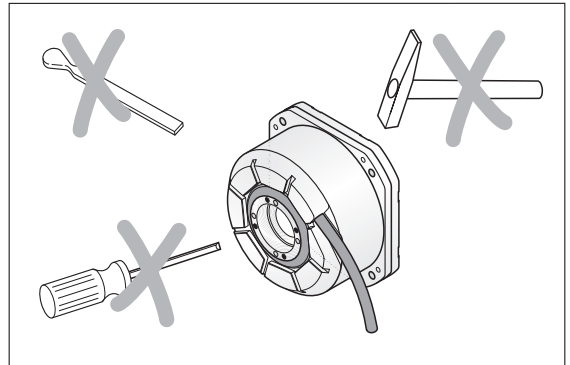
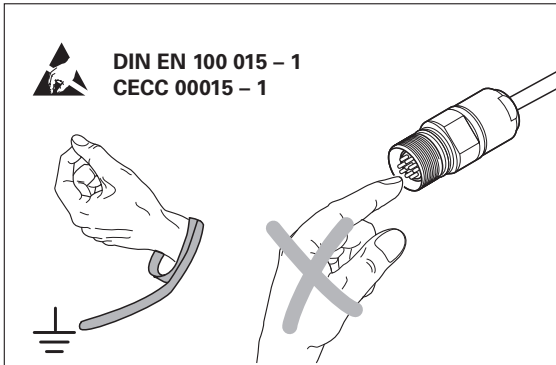
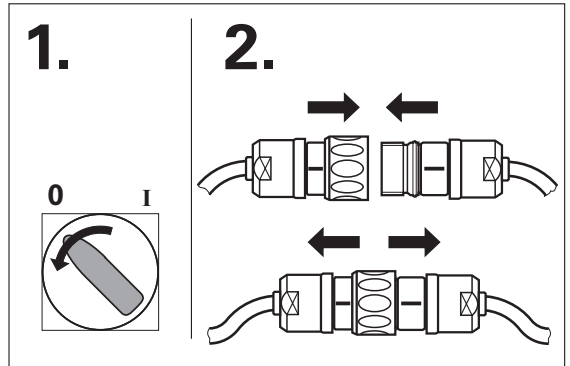

mm



Tolerancing ISO 8015  
ISO 2768 - m H

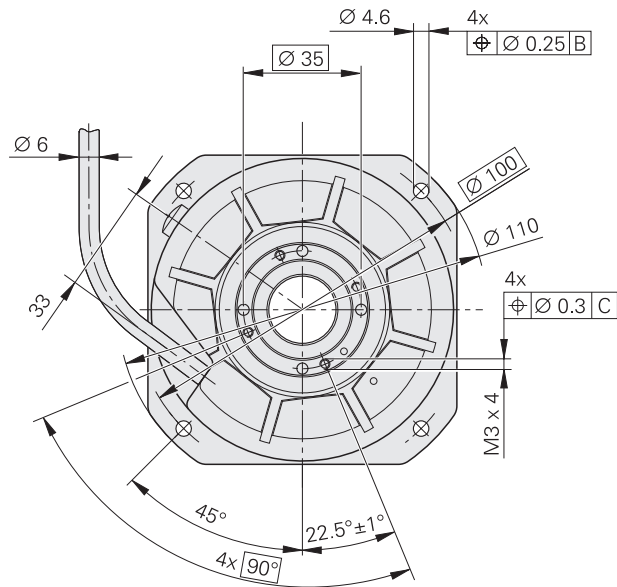

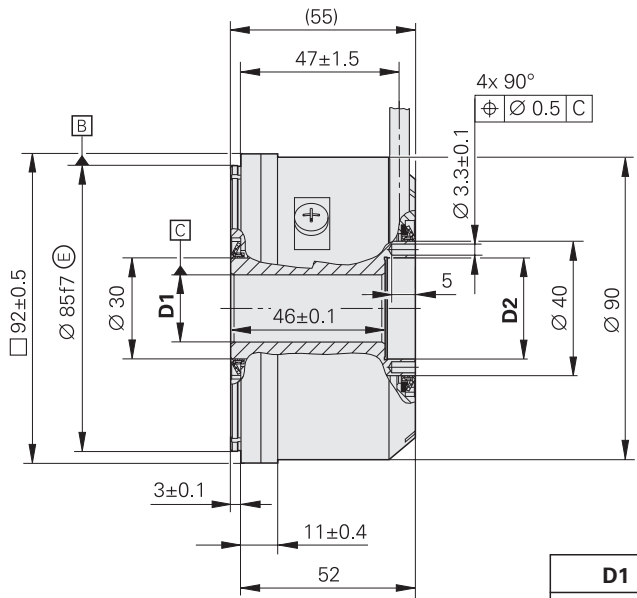

D1	D2
Ø 20H7 E	Ø 30H7 E
Ø 22H7 E	



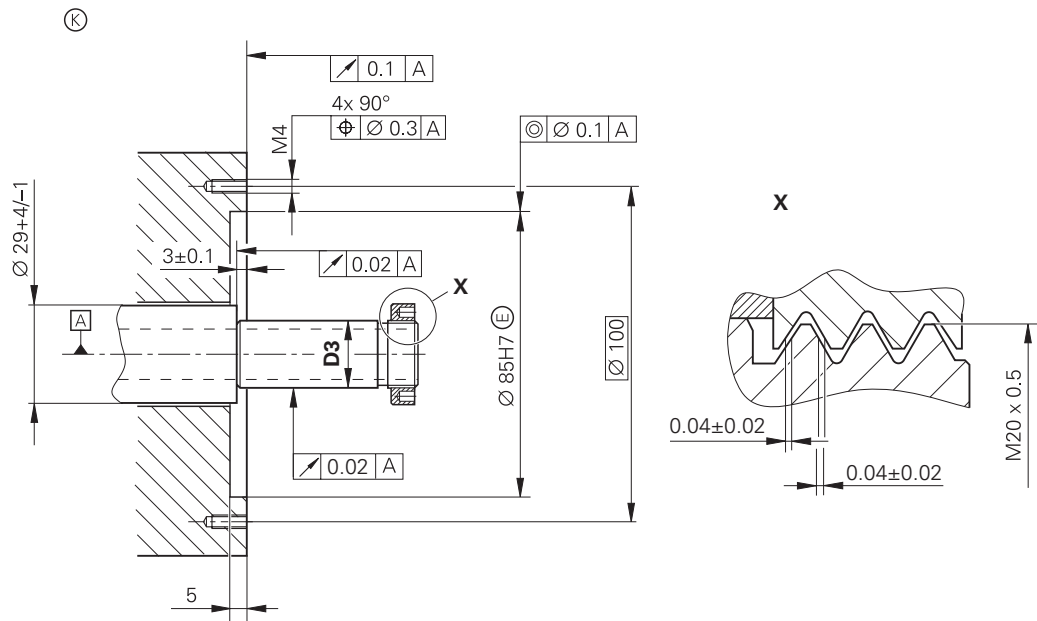

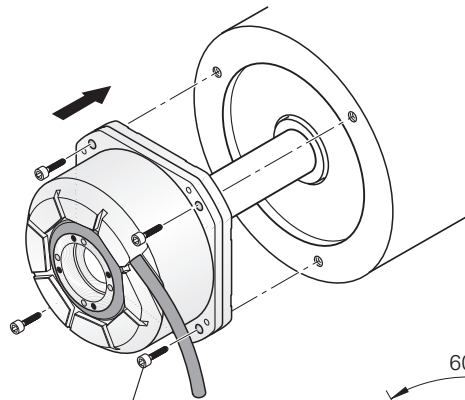

4 x M4  
**M<sub>d</sub>** = 2.5 Nm

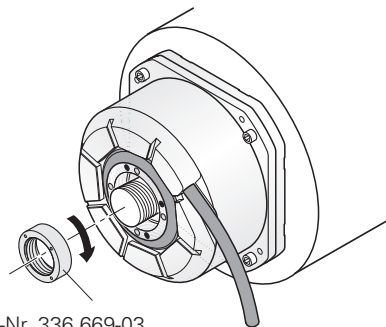

Id.-Nr. 336 669-03

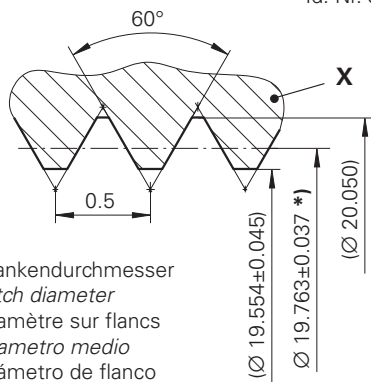

\*) Flankendurchmesser  
*Pitch diameter*  
 Diamètre sur flancs  
*Diametro medio*  
 Diámetro de flanco

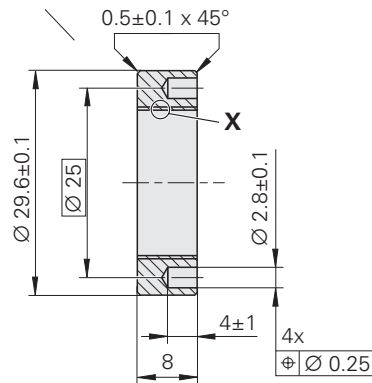

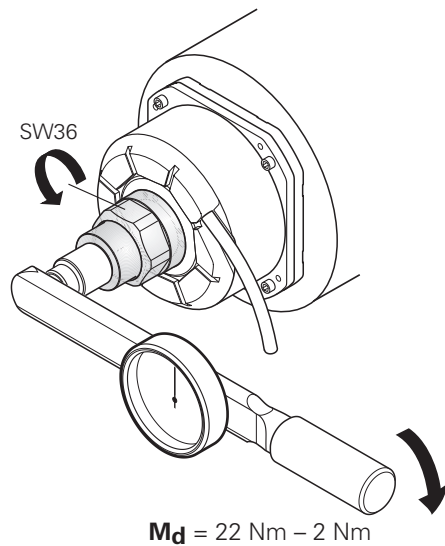
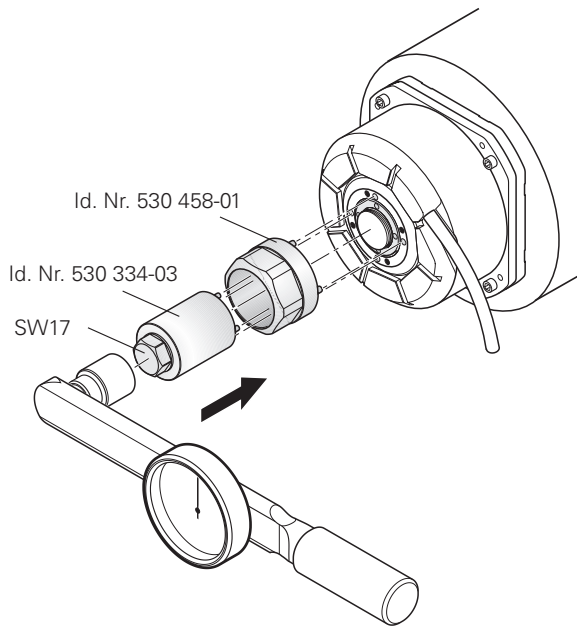

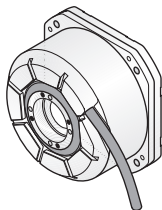
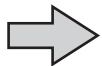

$U_P = 5\text{ V} \pm 10\%$   
(max. 150 mA)



EN 50 178/4.98; 5.2.9.5  
IEC 364-4-41: 1992; 411(PELV/SELV)

(siehe, see, voir, vedi, véase  
HEIDENHAIN D 231 929)

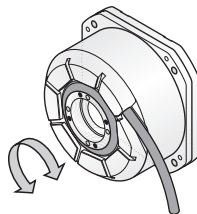

Z = Strichzahl  
*Line count*  
Nombre de traits  
*Numero di impulsi*  
Número de impulsos

$$n \leq \begin{cases} \frac{180}{Z} \cdot 10^3 \cdot 60 \text{ min}^{-1} (-3\text{dB}) \\ 3\,000 \text{ min}^{-1} \end{cases}$$

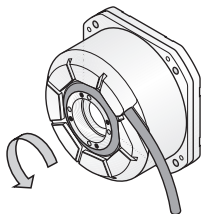

A, B, R

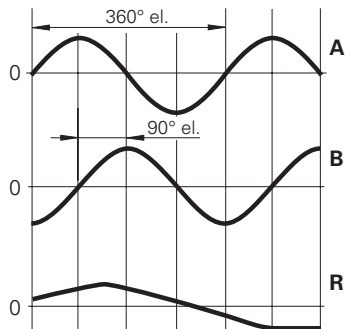

**RON 285:** 1xR  
**RON 285C:** 36xR

**A, B**

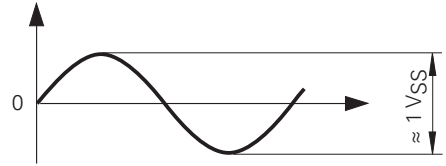

**R**

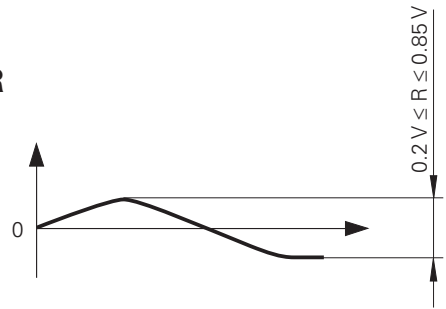

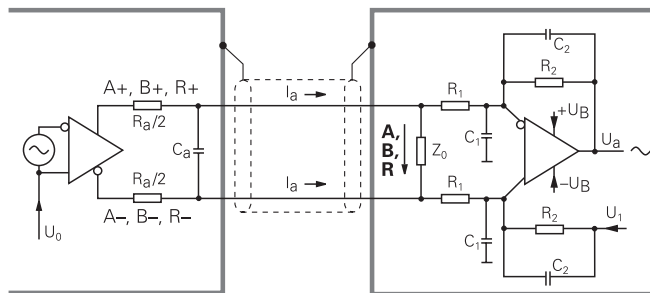
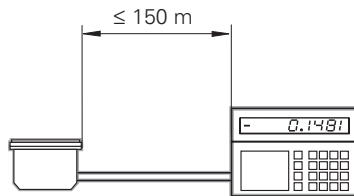

$$R_a < 100 \Omega$$

$$C_a < 50 \text{ pF}$$

$$\Sigma I_a < 1 \text{ mA}$$

$$U_0 = 2.5 \text{ V} \pm 0.5 \text{ V}$$

$$Z_0 = 120 \Omega$$

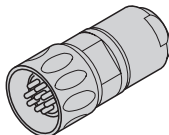
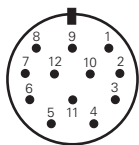
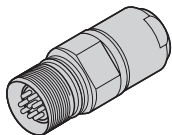
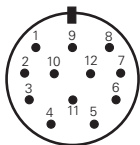

$$U_1 \approx U_0$$

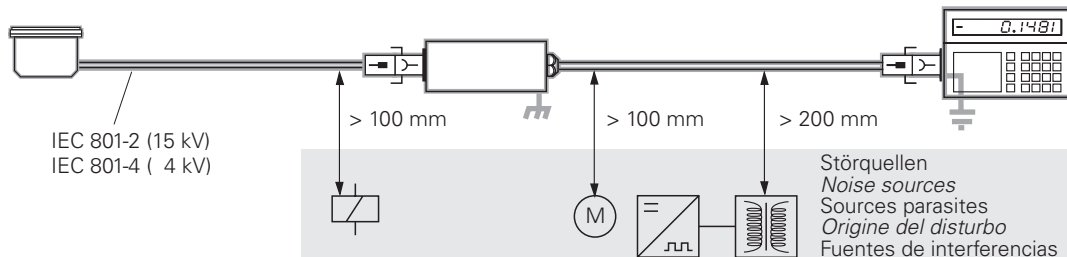

Schirm auf Gehäuse  
Shield on housing  
Blindage sur boîtier  
Schermo sulla carcassa  
Blindaje a carcasa

5	6	8	1	3	4	12	10	2	11	7	/
A		B		R		5V Up	0V U <sub>N</sub>	5V sensor	0V sensor	/	/
+	-	+	-	+	-						
braun <i>brown</i> brun <i>marrone</i> marrón	grün <i>green</i> vert <i>verde</i> verde	grau <i>gray</i> gris <i>grigio</i> gris	rosa <i>pink</i> rose <i>rosa</i> rosa	rot <i>red</i> rouge <i>rosso</i> rojo	schwarz <i>black</i> noir <i>nero</i> negro	braun/grün <i>brown/green</i> brun/vert <i>marrone/verde</i> marrón/verde	weiß/grün <i>white/green</i> blanc/vert <i>bianco/verde</i> blanco/verde	blau <i>blue</i> bleu <i>azzurro</i> azul	weiß <i>white</i> blanc <i>bianco</i> blanco	violett <i>violet</i> violet <i>viola</i> violeta	gelb <i>yellow</i> jaune <i>giallo</i> amarillo

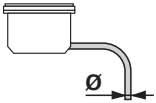
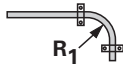
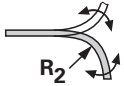

	 <p><math>T \geq -40 \text{ °C}</math> (-40 °F)</p>	 <p><math>T \geq -10 \text{ °C}</math> (14 °F)</p>
<p><b>Ø 6 mm</b></p>	<p><math>R_1 \geq 20 \text{ mm}</math></p>	<p><math>R_2 \geq 75 \text{ mm}</math></p>
<p><b>Ø 8 mm</b></p> 	<p><math>R_1 \geq 40 \text{ mm}</math></p>	<p><math>R_2 \geq 100 \text{ mm}</math></p>

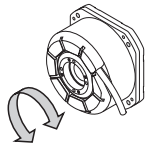

**$M_d \leq 0.08 \text{ Nm}$**  (20 °C)  
 **$I = 73 \cdot 10^{-6} \text{ kgm}^2$**

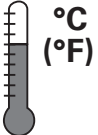

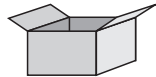

-30 ... 80 °C  
(-22 ... 176 °F)

# HEIDENHAIN

---

## DR. JOHANNES HEIDENHAIN GmbH

Dr.-Johannes-Heidenhain-Straße 5

**83301 Traunreut, Germany**

☎ +49 (8669) 31-0

[FAX] +49 (8669) 5061

e-mail: [info@heidenhain.de](mailto:info@heidenhain.de)

---

**Technical support** [FAX] +49 (8669) 31-1000

**Measuring systems** ☎ +49 (8669) 31-3104

e-mail: [service.ms-support@heidenhain.de](mailto:service.ms-support@heidenhain.de)

**TNC support** ☎ +49 (8669) 31-3101

e-mail: [service.nc-support@heidenhain.de](mailto:service.nc-support@heidenhain.de)

**NC programming** ☎ +49 (8669) 31-3103

e-mail: [service.nc-pgm@heidenhain.de](mailto:service.nc-pgm@heidenhain.de)

**PLC programming** ☎ +49 (8669) 31-3102

e-mail: [service.plc@heidenhain.de](mailto:service.plc@heidenhain.de)

**Lathe controls** ☎ +49 (711) 952803-0

e-mail: [service.hsf@heidenhain.de](mailto:service.hsf@heidenhain.de)

---

[www.heidenhain.de](http://www.heidenhain.de)

Ve 03

363 469-92 · 25 · 2/2005 · F&W · Printed in Germany

Änderungen vorbehalten · *Subject to change without notice* · Sous réserve de modifications · *Con riserva di modifiche* · Sujeto a modificaciones

